

# Cilindro Retificado Sólido

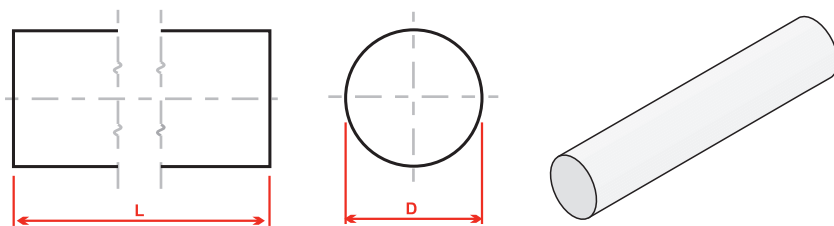

DIÂMETRO	TOLERÂNCIA - H6
3,0	-0,006
4,0	-0,008
5,0	-0,008
6,0	-0,008
7,0	-0,009
8,0	-0,009
9,0	-0,009
10,0	-0,009
12,0	-0,011
14,0	-0,011
16,0	-0,011

\* Todas as dimensões em mm.